

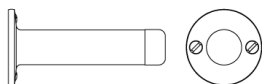

N° 9056

The No 9056 modern doorstop with exposed screws, cylindrical shaft and hemispherical rubber tip is wall or baseboard mounted. All Nanz plated and patinated finishes are available.



Diameter: 1-5/8"

Length: 3-3/8"

NEW YORK BOSTON CHICAGO MIAMI LOS ANGELES SAN FRANCISCO LONDON

THE NANZ COMPANY 121 VARICK STREET NEW YORK NY 10013 212 367 7000 NANZ.COM