

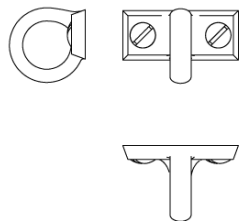

N° 8999

The No 8999 mid-century ring pull, based on an antique design, features a simple finger loop and chamfered rectangular backplate with two exposed screws. It is suitable for a variety of uses, such as on cabinets and drawers. All NANZ plated and patinated finishes are available.



Center-to-Center: 1-1/8"
Length: 1-3/4"
Projection: 1-1/8"
Collection: Moderne