

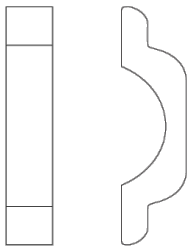

N° 8863

The N° 8863 surface mounted cabinet pull balances a stepped profile with subtle curves and a crescent finger space. Suitable for cabinet doors and drawers, the pull is available in all Nanz plated and patinated finishes.



Width: 4"  
Center-to-Center: 3"  
Projection: 1-3/32"

NEW YORK BOSTON CHICAGO MIAMI LOS ANGELES SAN FRANCISCO LONDON

THE NANZ COMPANY 121 VARICK STREET NEW YORK NY 10013 212 367 7000 NANZ.COM

© 1989-2017 ALL RIGHTS RESERVED