

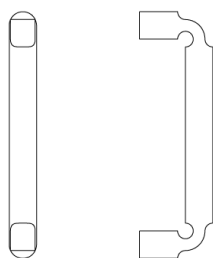

N° 8500

The N° 8500 modern handle embodies a minimalistic aesthetic with its simple cylindrical body and clearly defined bend. While the handle is simple in form, the unique design is hard to overlook. It can be mounted horizontally as a drawer pull or vertically as a cabinet pull. The simple cylindrical body of the pull is defined by its flat cut-out bend inspired by the N° 2500 lever. All Nanz finishes are available. U.S. Patent No. D709,347 S



Center-to-Center: 4" 6" 8"

Projection: 1-3/8"

NEW YORK BOSTON CHICAGO MIAMI LOS ANGELES SAN FRANCISCO LONDON

THE NANZ COMPANY 121 VARICK STREET NEW YORK NY 10013 212 367 7000 NANZ.COM