

N° 6078

The No 6078 hexagonal recessed pull juxtaposes flat and sculptural forms to create a complex surface. The flat outer edge transitions to the raised center through a faceted, angled hexagon. The No 6078 is designed to operate pocket doors. It is available in all NANZ plated and patinated finishes.

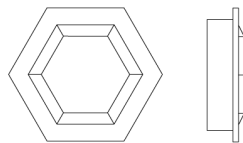

Diameter: 3"

Depth: 1/2"

Collection: Prismatic