

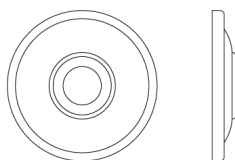

N° 5229

The No 5229 rosette features a shallow ogee enclosed by a steep astragal. It is recommended to use with contemporary knobs or levers, however can be manufactured to accommodate every style. It is available in all NANZ plated and patinated finishes.



Diameter: 2-1/2" 2-3/4" 5"

NEW YORK BOSTON CHICAGO MIAMI LOS ANGELES SAN FRANCISCO LONDON

NANZ & COMPANY 121 VARICK STREET NEW YORK NY 10013 212 367 7000 NANZ.COM