

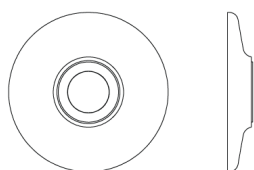

### N° 5017CF

The N° 5017CF emphasizes a formal approach with its three concealed fasteners and the dome-like surface of the rose that terminates in a slight rise at the shank, creating a shallow ogee. All NANZ plated and patinated finishes are available.



Diameter: 1-3/4" 2"

NEW YORK BOSTON CHICAGO MIAMI LOS ANGELES SAN FRANCISCO LONDON

NANZ & COMPANY 121 VARICK STREET NEW YORK NY 10013 212 367 7000 NANZ.COM