

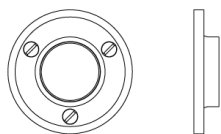

N° 9885CBN

Designed in collaboration with Clos-ette, the N° 9885CBN closet rod flange with box-molding detail features exposed fasteners and is provided with oval-head screws to match the surrounding hardware. This flange can be provided in custom sizes upon request. Available in all standard plated and patinated finishes.



Diameter: 3" x 3-1/10"

Projection: 5/8"

NEW YORK BOSTON CHICAGO MIAMI LOS ANGELES SAN FRANCISCO LONDON

THE NANZ COMPANY 121 VARICK STREET NEW YORK NY 10013 212 367 7000 NANZ.COM